

1407

KEBET WAY
PORT COQUITLAM, BC

**LEE &
ASSOCIATES**
COMMERCIAL REAL ESTATE SERVICES



FOR SALE

**40,321 SF THREE-BAY BUILDING – 14,628 SF AVAILABLE
IMMEDIATELY PLUS STRONG TENANT INCOME**

Steve Caldwell

Personal Real Estate Corporation
D 604.895.2224 C 604.809.3122
steve.caldwell@lee-associates.com

Mackenzie Fraser

D 604.630.3386 C 604.671.9441
mackenzie.fraser@lee-associates.com

1407

KEBET WAY
PORT COQUITLAM, BC

OPPORTUNITY

Presenting an opportunity to purchase a high-quality Beedie-built warehouse on a corner lot at Kebet Way and Mustang Place in Meridian Industrial Park. This property features beautiful offices with views of the Pitt River and is ideally situated just 36 minutes from downtown and five minutes east of Highway 1 via the Mary Hill Bypass.

Ideal for owner-occupiers, this property offers the opportunity to utilize over one-third of the building immediately, with potential for expansion to part or all of the remaining building in the coming years.



Salient Details

Legal Description	Lot A (BK340976) Sections 18 and 19 Block 6 North Range 1 East NWD Plan LMP 19051	
PID	023-589-175	
Zoning	M-1 (General Industrial)	
Site Area	1.586 acres	
Building Size	Warehouse	28,472 SF
	Main floor office	4,621 SF
	Second floor office	4,606 SF
	Mezzanine office/storage	2,622 SF
	Total	40,321 SF
Construction	Tilt-up concrete with extensive glazing	
Tenancy	Stericycle ULC 25,693 SF, expires February 28, 2027 (Contact listing agents for tenancy details and data room)	
Property Taxes	\$175,175.18 (2024)	
Asking Price	Contact listing agents	

Property Features

- ▶ Quality construction by Beedie
- ▶ Fully air-conditioned office areas
- ▶ Large mezzanine with training classroom
- ▶ Full nighttime exterior security illumination
- ▶ All hot water tanks recently replaced
- ▶ Five (5) dock doors with levellers, two (2) 12' x 14' drive-in doors
- ▶ Three (3) 64' wide clear span bays
- ▶ 24' ceiling height
- ▶ Overhead gas warehouse heaters
- ▶ Three (3) skylights per bay, LED warehouse lighting
- ▶ 600 amp 600 volt power
- ▶ Oversize gas line
- ▶ Lunchroom with outside patio
- ▶ Fully sprinklered
- ▶ Ample truck room and parking

Floor Plan

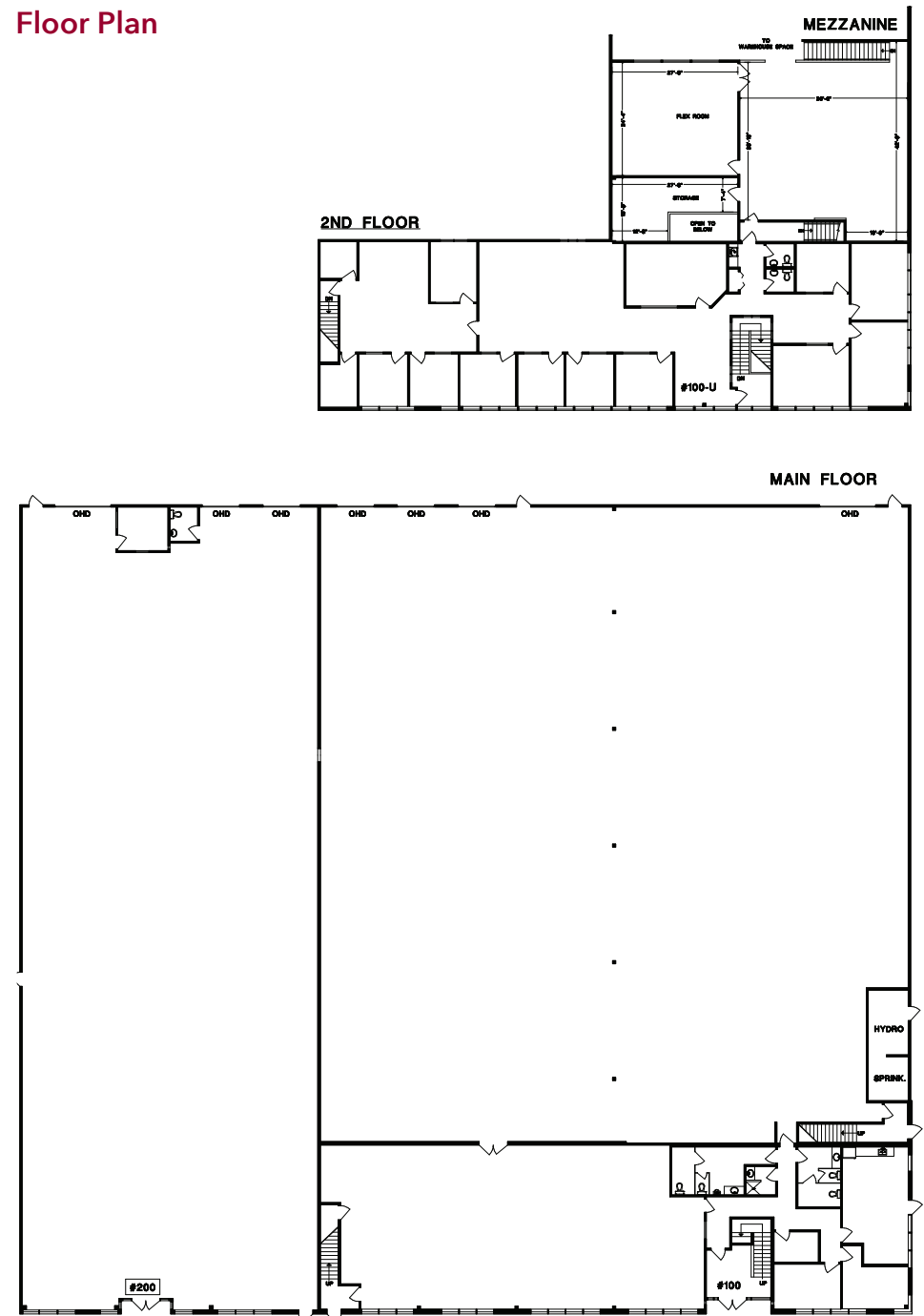

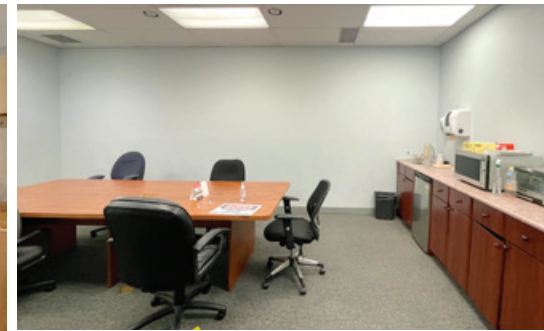

Steve Caldwell
Personal Real Estate Corporation
D 604.895.2224 C 604.809.3122
steve.caldwell@lee-associates.com

Mackenzie Fraser
D 604.630.3386 C 604.671.9441
mackenzie.fraser@lee-associates.com

 **LEE &
ASSOCIATES**
COMMERCIAL REAL ESTATE SERVICES

© 2024 Lee & Associates Commercial Real Estate (BC) Ltd. ("Lee & Associates Vancouver"). All Rights Reserved. E. & O.E.: Although the information contained within is from sources believed to be reliable, no warranty or representation is made by Lee & Associates Vancouver as to its accuracy being subject to errors, omissions, conditions, prior lease, withdrawal or other changes without notice and same should not be relied upon without independent verification.

475 West Georgia Street, Suite 800 | Vancouver, BC V6B 4M9 | 604.684.7117 | leevancouver.com