

FOR LEASE | RETAIL
2255 EAST HASTINGS STREET
VANCOUVER, BC



- ▶ **Approximately 863 SF High Exposure Retail Space**
- ▶ **Centrally Located in the Heart of East Vancouver's East Village District**

Location

The subject property is located on the north side of Hastings Street between Templeton Drive and Garden Drive in the East Village Neighbourhood. The East Village is located within two historic neighbourhoods in the heart of East Vancouver – Hastings-Sunrise and Grandview-Woodland.

Tony Capolongo
D 604.630.3378 C 604.290.5318
tony.capolongo@lee-associates.com



GROUND FLOOR PLAN

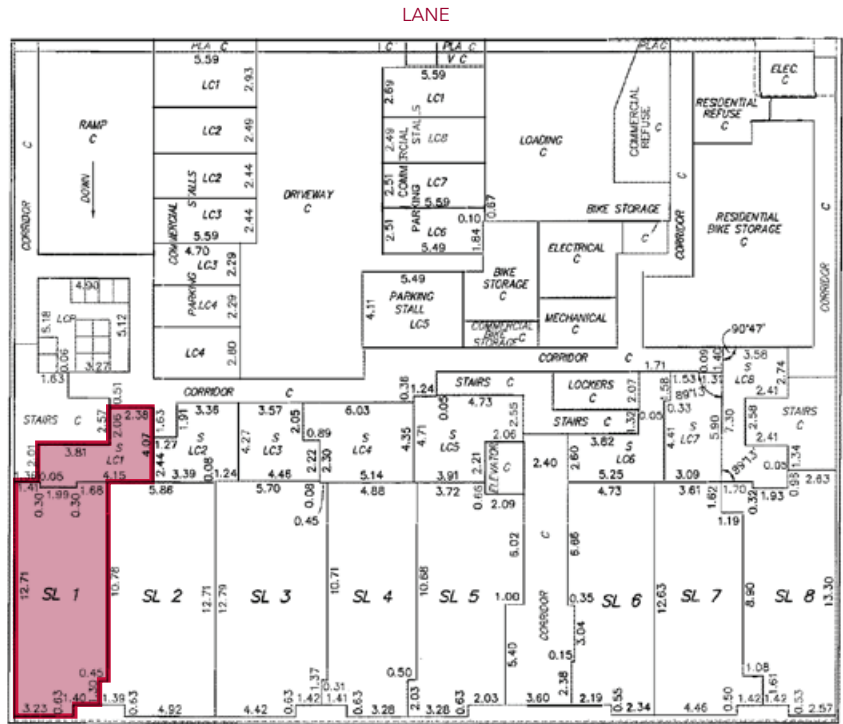

EAST HASTINGS STREET

Zoning

C-2C1

Features

- ▶ Move-in ready
- ▶ Sprinklered
- ▶ Multiple sinks
- ▶ One washroom
- ▶ Former tattoo location
- ▶ Two parking stalls
- ▶ Air-conditioned
- ▶ 3-phase electrical

Available Space

863 SF (approximate)

Basic Rent

\$42.00 PSF

Taxes & Operating Costs

\$16.36 PSF (2024 estimate)

Availability

February 1, 2025

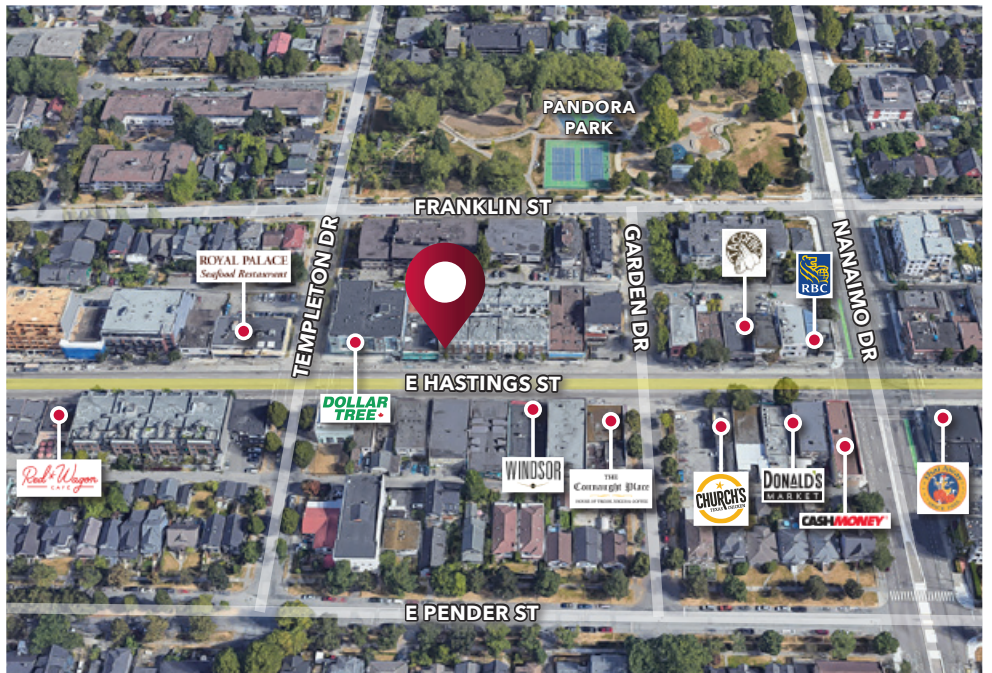

Tony Capolongo

D 604.630.3378 C 604.290.5318

tony.capolongo@lee-associates.com