

3265 264 STREET
LANGLEY, BC

WATCH VIDEO



INDUSTRIAL LAND & SHOP **FOR SALE**

1.94 Acres of Prime Industrial Land with Shop and Office Space

9,604 SF of Versatile Warehouse and Office Areas

Strategic Location with Easy Access to Major Highways and US Border

Sebastian Espinosa CCIM, SIOR

Personal Real Estate Corporation

Senior Vice President | Industrial

D 604.630.3396 C 604.783.8139

sebastian.espinosa@lee-associates.com

Grant Basran

Associate Vice President | Industrial

D 604.630.3376 C 604.518.2188

grant.basran@lee-associates.com

 **LEE &
ASSOCIATES**
COMMERCIAL REAL ESTATE SERVICES

Opportunity

This property presents a unique opportunity to purchase 1.94 acres of rare fully serviced industrial land with shop/office space in the Aldergrove Industrial Submarket. The site boasts low site coverage, allowing for potential expansion or additional outdoor usage for a variety of industrial users. This parcel contains flat and partially paved/graveled area with an ideal shape suited for maneuvering large equipment or potential redevelopment.

Features

- » HVAC office
- » Multiple washrooms
- » Kitchenette/lunchroom
- » Multiple private offices
- » Alarmed
- » Four (4) grade loading doors (Quonset) - 3x (14' X 14') & 1x (8' X 8')
- » 24' ceilings (Quonset)
- » Radiant tube heating (Quonset)
- » Three (3) grade loading doors 11' X 14' (warehouse)
- » Forced air heaters (warehouse)
- » 16' ceilings (warehouse)
- » One (1) grade loading door (10' X 11') (storage room)



EXCELLENT PYLON SIGNAGE



MODULAR OFFICE



Site Size	1.94 Acres	
Available Area	Warehouse/Quonset Hut	6,885 SF
	Warehouse Mezzanine	1,297 SF
	Modular Showroom/Office	702 SF
	Modular Office (Rear)	720 SF
	Total	9,604 SF
Zoning	M-2 (General Industrial)	
Property Taxes	\$94,352.30 (2024)	
PID	002-396-866	
Asking Price	Contact Listing Agent	
Possession	Contact Listing Agent	

Location Overview

The subject property offers immediate access to the designated truck routes and is minutes away from Highway 1, Highway 13, Fraser Highway and the Aldergrove US border crossing. Strategically situated just off Fraser Highway and 264th Street (Highway 13 - designated truck highway) and the expanding international border with over 138 feet of frontage to 264th Street, the site is ideal for businesses seeking a strategic and accessible location in the heart of Aldergrove. The surrounding area boasts a wealth of amenities and retail stores, with some conveniently highlighted in the map below.

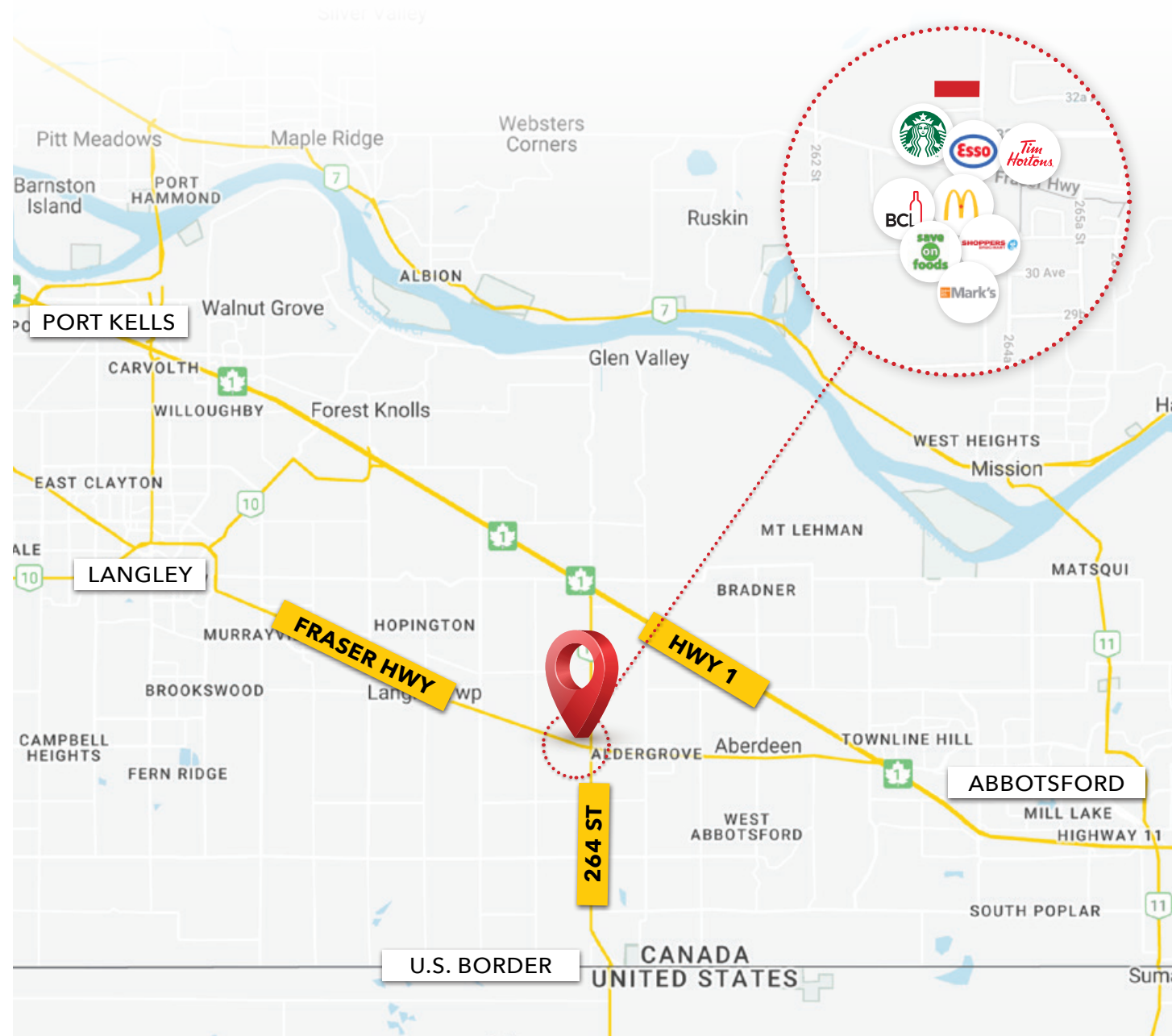

Building Areas

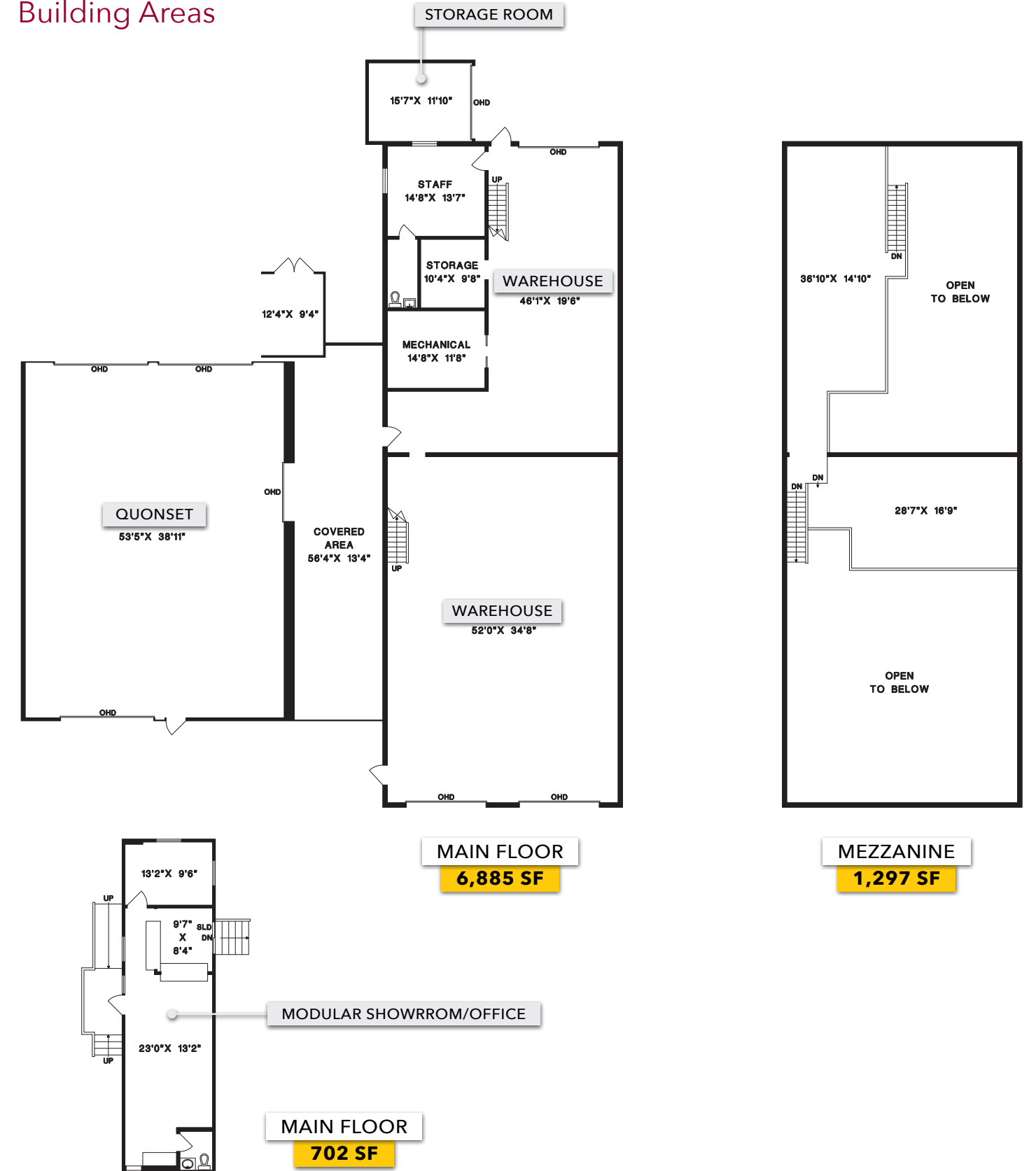

3265 264 STREET
LANGLEY, BC



INDUSTRIAL LAND & SHOP **FOR SALE**

Sebastian Espinosa CCIM, SIOR
Personal Real Estate Corporation
Senior Vice President | Industrial
D 604.630.3396 C 604.783.8139
sebastian.espinosa@lee-associates.com

Grant Basran
Associate Vice President | Industrial
D 604.630.3376 C 604.518.2188
grant.basran@lee-associates.com

LEE & ASSOCIATES
COMMERCIAL REAL ESTATE SERVICES

© 2024 Lee & Associates Commercial Real Estate (BC) Ltd. ("Lee & Associates Vancouver"). All Rights Reserved. September 8, 2024 9:57 PM. E. & O.E.: Although the information contained within is from sources believed to be reliable, no warranty or representation is made by Lee & Associates Vancouver as to its accuracy being subject to errors, omissions, conditions, prior lease, withdrawal or other changes without notice and same should not be relied upon without independent verification.

CELEBRATING OVER
150
YEARS IN VANCOUVER